

2000 I-30 E
Greenville, TX 75402

Monday, April 3, 2023

Office of Hopkins County Judge
PO Box 288
Sulphur Springs TX 75483

Farmers Electric Cooperative Member: Gloria Burgan
Service Order Number: 2022125731

Greetings:

Farmers Electric Cooperative, Inc. is requesting permission to construct electrical power distribution facilities which will cross County Road 2436 which is located 1.2 miles east of County Road 1439 in Hopkins County, Texas.

Site location map and construction sketches are enclosed. The construction sketch details the proposed work. All road crossings will have a minimum vertical clearance of 22 feet.

If you have any questions, please contact me at any time.

Sincerely,

Tamara Williams
Project Coordinator
twilliams@farmerselectric.coop
Phone 903-513-2903

Submitted by Shaya Smith
ssmith@farmerselectric.coop
Field Engineering Coordinator

Enclosures

County Approval Section:

Approved: X Denied: _____

Authorized Signature: *AS* Date: _____

Farmers Electric Cooperative

2000 I-30 E
Greenville, TX 75402

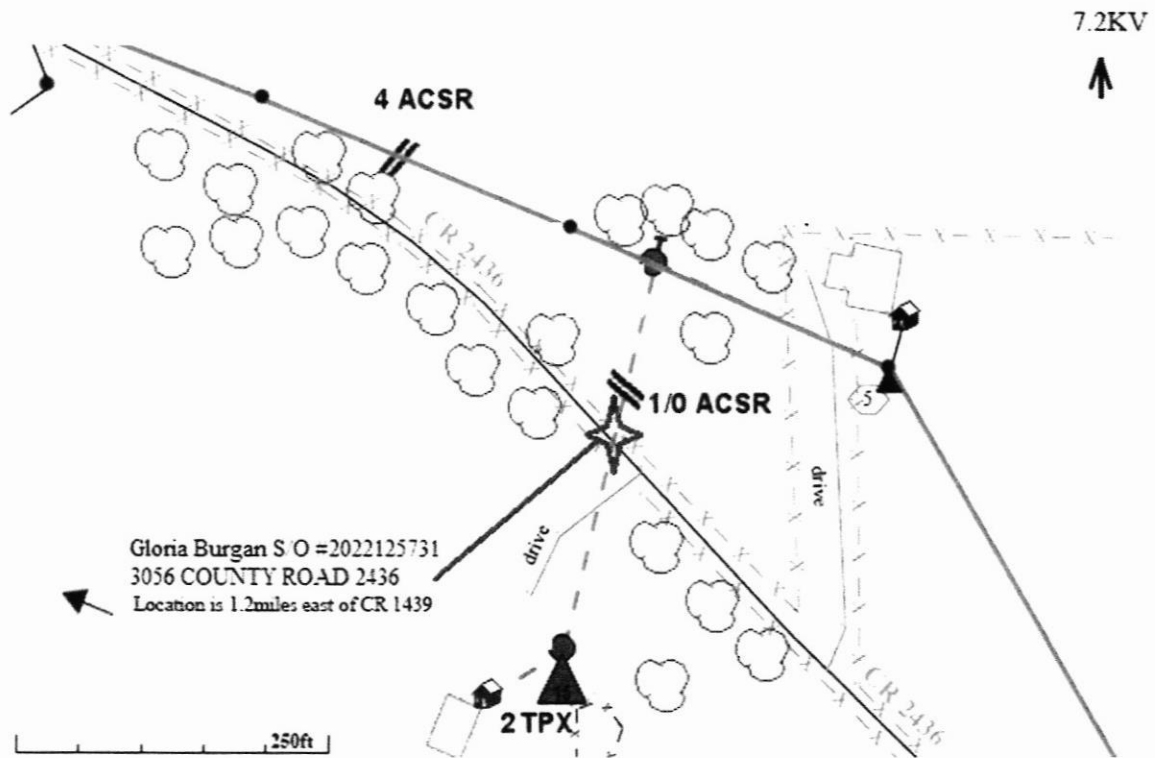



2000 I-30 E
Greenville, TX 75402

Tuesday, April 4, 2023

Office of Hopkins County Judge
PO Box 288
Sulphur Springs TX 75483

Farmers Electric Cooperative Member: CHARTER COMMUNICATIONS
Service Order Number: 2023033010

Greetings:

Farmers Electric Cooperative, Inc. is requesting permission to construct electrical power distribution facilities which will cross County Road 3528 which is located 1100' E OF CR 3532 in Hopkins County, Texas.

Site location map and construction sketches are enclosed. The construction sketch details the proposed work. All road crossings will have a minimum vertical clearance of 22 feet.

If you have any questions, please contact me at any time.

Sincerely,

Catherine Rollins
Project Coordinator
crollins@farmerselectric.coop
Phone 903-513-0259

Submitted by Psalm Harper
pharper@farmerselectric.coop
Engineering Coordinator

Enclosures

County Approval Section:

Approved: Denied:

Authorized Signature: *W. B. Burt* Date: 4-10-23

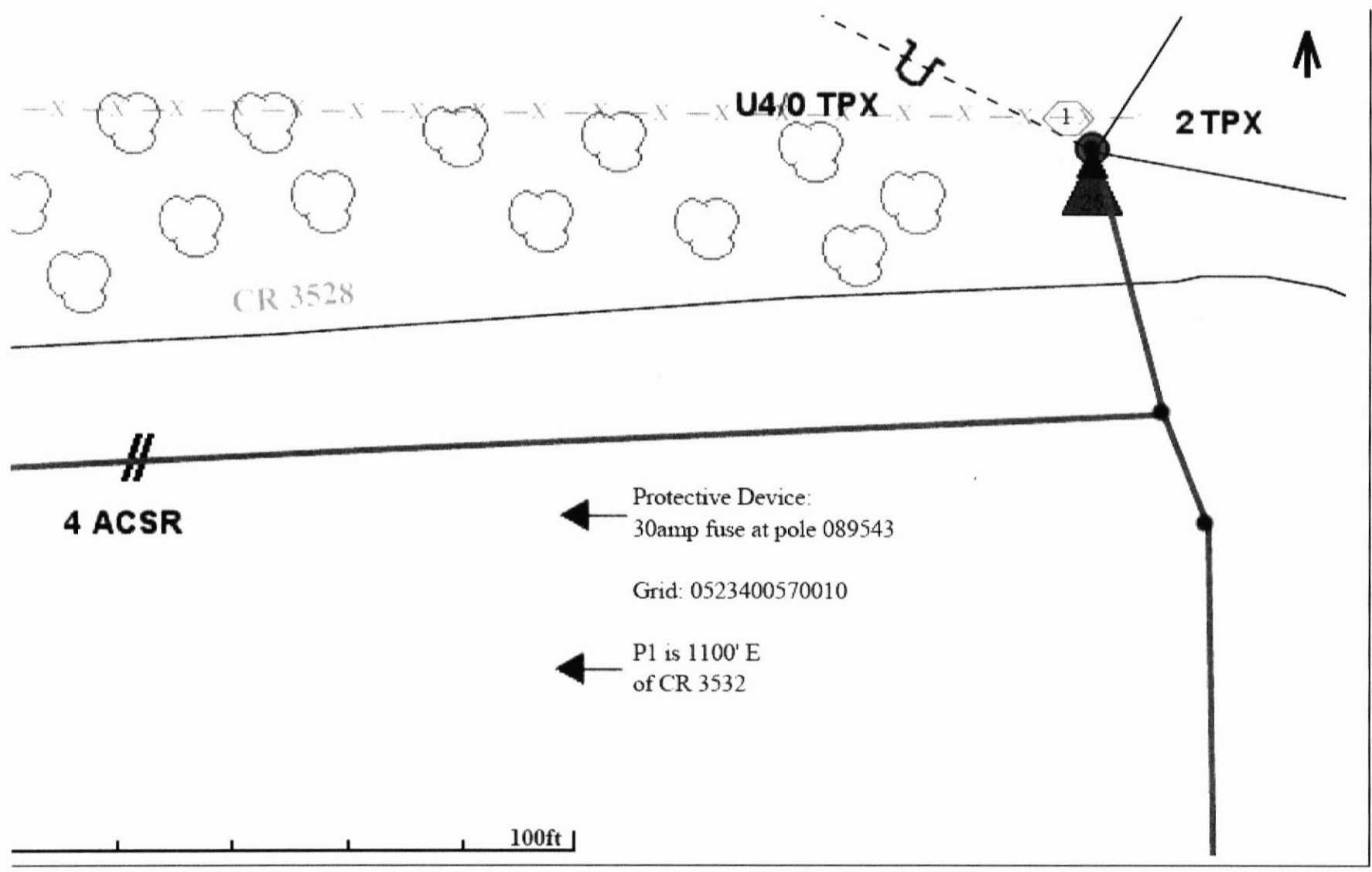

U4/0 TPX

2 TPX

CR 3528

4 ACSR

Protective Device:
30amp fuse at pole 089543

Grid: 0523400570010

P1 is 1100' E
of CR 3532

100ft

CROSSING CR 3528 AT POLE 089549 WHICH IS 1100' E OF CR 3532

SALTILLO RHSD

NORTH EAST SERVICE AREA

MARTIN ALLAIN

5

502

75478

EAST SERVICE AREA

23400570010

002431

000517

PKINS
County Road 3528 No